

ProBlue® , ProBlue Liberty™ , DuraBlue®, or Mesa™ Thermostat Service Kit - P/N KNS0108

This instruction sheet describes the procedure for replacing a manifold or tank thermostat in a ProBlue, DuraBlue, or Mesa adhesive melter or the manifold or grid thermostat in a ProBlue Liberty adhesive melter.

NOTE: These instructions do not apply to the Freedom® melters. Refer to the Freedom melter manual for proper repair/replacement procedures.

WARNING: Risk of personal injury or equipment damage! Refer to the safety information provided in the melter manual before servicing the melter. Failure to comply with the safety information provided can result in personal injury, including death.

Tools:
3-mm hex wrench
4-mm hex wrench
6-mm hex wrench

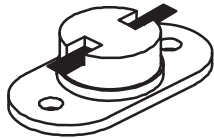

Thermostat



M4 screws (spare)



Thermal compound

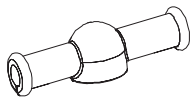

Boot

ProBlue Adhesive Melters

Replacing the Manifold Thermostat

WARNING: Risk of electrocution! The manifold heater terminals carry high voltage. Before Removing the back panel of the melter, ensure that power to the melter is disconnected at the local power disconnect. Failure to properly disconnect power from the melter can result in personal injury, including death.

1. Disconnect power to the melter at the local power disconnect switch.
2. Switch the melter off.
3. Remove the top and back panels.

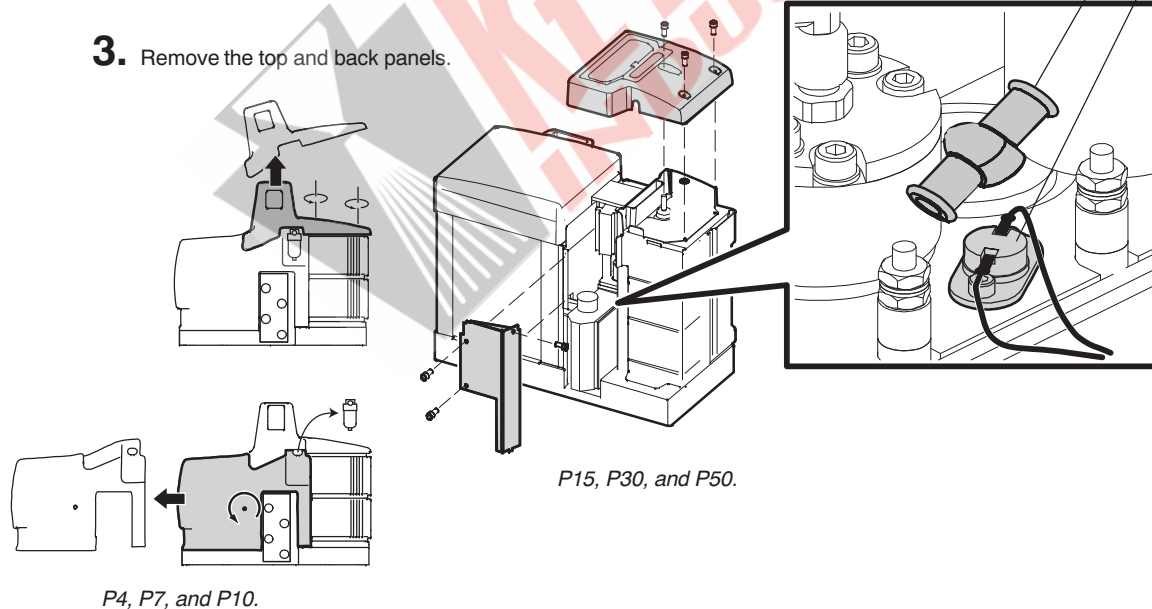

DuraBlue instructions on page 5.

4. Remove the boot from the top of the thermostat, if present.
5. Disconnect the thermostat leads, and then remove the two M4 screws. Discard the old thermostat.
6. Clean any residue off of the thermostat mating surface on the manifold.
7. Apply thermal compound to the replacement thermostat, install it using the M4 screws, and then connect the leads.
8. Install the boot over the thermostat.
9. Reinstall the back and top panels.
10. Apply power to the melter, switch the melter on, and verify that the melter heats normally. If the melter does not heat normally, refer to the troubleshooting section of the melter manual.

Replacing the Tank Thermostat — P4, P7, and P10

DuraBlue instructions on page 5.

- To replace the tank thermostat you must first remove the pump. If the temperature of the tank is below 120 °C (250 °F) it may not be possible to remove the pump until the melter is reheated.

- Switch the melter off.

- Relieve system hydraulic pressure. Refer to the melter manual for information on relieving hydraulic pressure.

- Remove the pump as follows:

- Rotate the isolation valve handle upward until it is vertical.

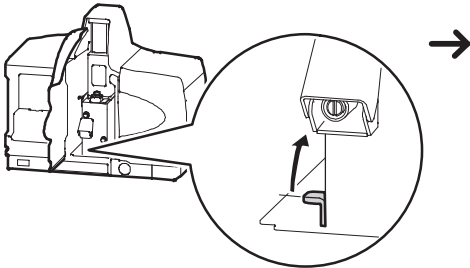

- Remove the three pump-mounting bolts.

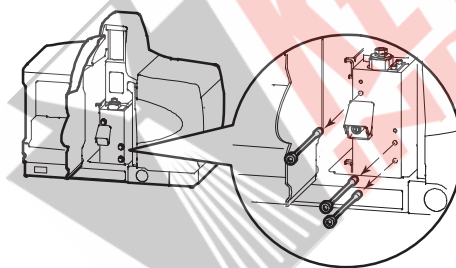

- While pulling the pump away from the manifold, tilt the top of the pump toward the front of the melter and then disconnect the air line from the back of the pump.

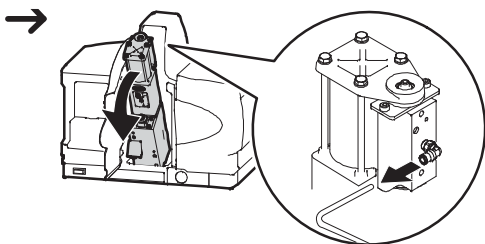

- Lift the pump clear of the melter.

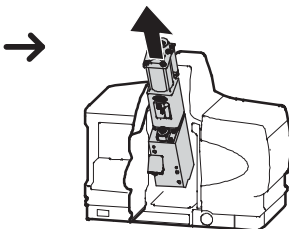

Note: To gain leverage when removing the pump, thread long M6 bolts into the two holes located on the face of the pump body.

To Reheat the Melter:

a. While pressing both the Setup and the Tank key, cycle the control switch off and then on again. The left display will flash to indicate that the melter is heating in the override mode. The melter will continue to reheat for 20 minutes and then automatically switch off.

b. To continue reheating the melter, repeat step a. until the melter reaches 120 °C (250 °F).

- To expose the tank thermostat, carefully cut or peel the tape at the corner of the tank insulating blanket.

Note: The tank thermostat is located to the left of the tank RTD and behind the insulating blanket that surrounds the tank.

- Remove the boot, if present.

- Disconnect the thermostat leads, and then remove the two M4 screws. Discard the old thermostat.

- Clean any residue off of the thermostat mating surface on the tank.

- Apply thermal compound to the replacement thermostat, install it using the M4 screws, and then connect the leads.

- Install the boot over the thermostat.

- Replace or repair the tape. Use heat-resistant tape only.

- Replace the top and bottom manifold O-rings if necessary (top—P/N 1019515; bottom—P/N 942111).

CAUTION: When reinstalling the pump, ensure that the RTD is fully seated in its slot and that the RTD wires are not pinched between the pump and the manifold.

- Reinstall the pump by reversing the sequence shown in step 4.

- Apply power to the melter, switch the melter on, and verify that the melter heats normally. If the melter does not heat normally, refer to the troubleshooting section of the melter manual.

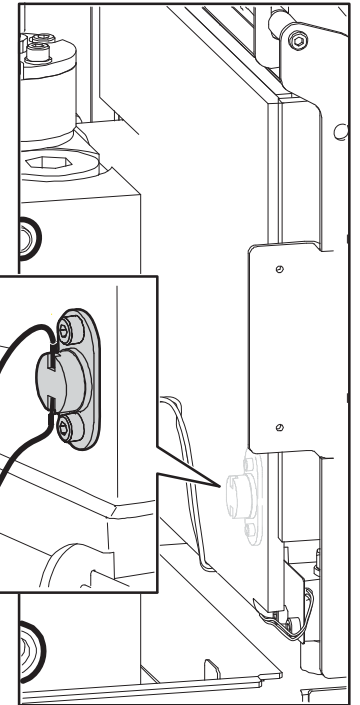

Continue



Replacing the Tank Thermostat — P15, P30, P50, and Mesa

DuraBlue instructions on page 5.

1. Remove the front panel (ProBlue) or side panel (Mesa)

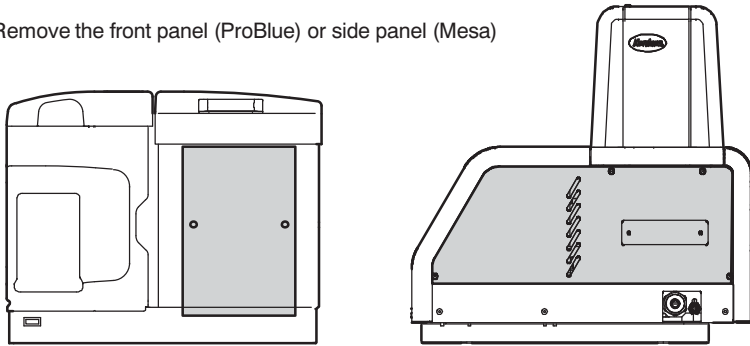

2. Lift the flap in the tank insulation to expose the thermostat.

3. Remove the boot, if present.

4. Disconnect the thermostat leads, and then remove the two M4 screws. Discard the old thermostat.

5. Clean any residue off of the thermostat mating surface on the tank.

6. Apply thermal compound to the replacement thermostat, install it using the M4 screws, and then connect the leads.

7. Install the boot over the thermostat.

8. Close the tank insulation flap.

9. Apply power to the melter, switch the melter on, and verify that the melter heats normally. If the melter does heat normally, refer to the troubleshooting section of the melter manual.

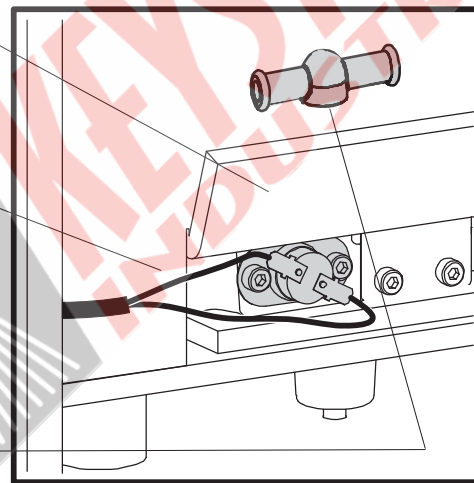

ProBlue 15/30/50 thermostat location

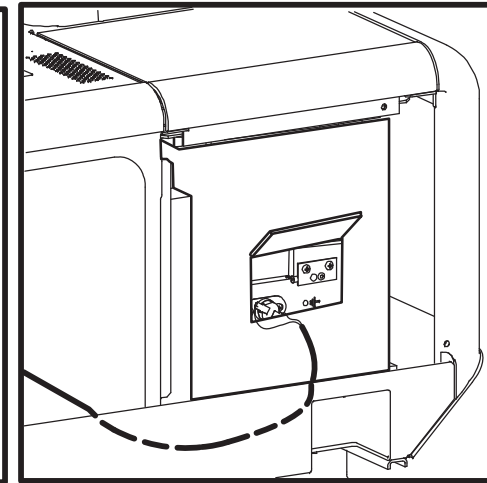

Mesa thermostat location

Continue



Replacing the Grid Thermostat — ProBlue Liberty L7 and L14

Access the Thermostat

1. Switch the melter off.
2. Disconnect the melter air supply and remove the air filter (1).
3. Remove the rear panel (2).
4. Open the pump enclosure door (5).
5. Remove the front (4) and end panels (6).

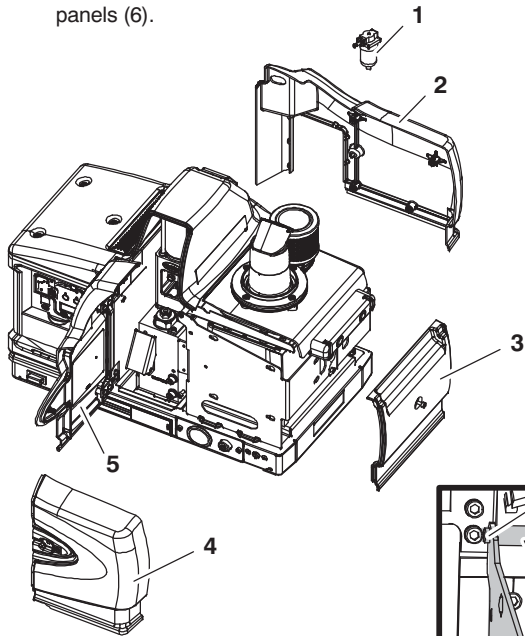

L7 melter shown

6. On L7 melters only, remove the screws holding the pneumatic control assembly in place and pull it out as far as the tubes and wires will allow.

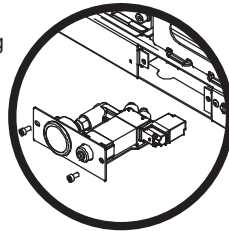

7. Remove the screws (5) that secure the rod (6) to the melt section brackets (7).

8. Remove the screws (8) that secure the melt section brackets together.

9. Fold the brackets to a horizontal position and then remove them from the chassis.

10. Unfasten the Velcro strips that secure the insulation to the right side of the grid/hopper and then fold the insulation down.

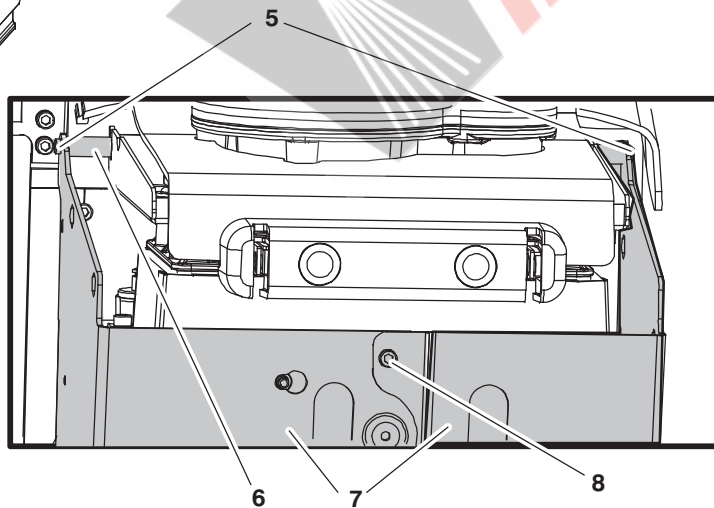

Replace the Thermostat

Note: The grid thermostat is located to the right of the grid RTD and behind the insulation that surrounds the grid assembly.

1. Remove the boot.
2. Disconnect the thermostat leads, and then remove the two M4 screws. Discard the old thermostat.
3. Clean any residue off of the thermostat mating surface on the tank.
4. Apply thermal compound to the replacement thermostat, install it using the M4 screws, and then connect the leads.
5. Install the boot over the thermostat.

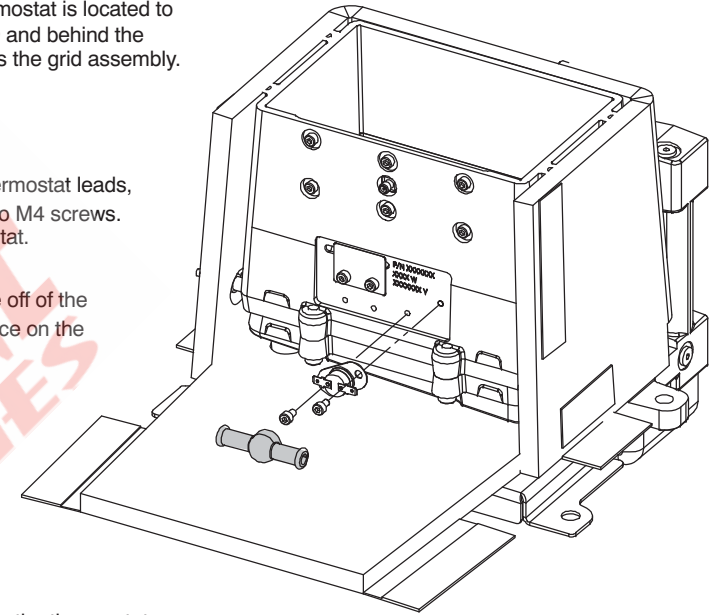

6. Restore the system to normal operation by:
 - closing the insulation
 - reinstalling the pneumatic assembly (L7 melters only)
 - reinstalling the melter panels

7. Apply power to the melter, switch the melter on, and verify that the melter heats normally. If the melter does not heat normally, refer to the troubleshooting section of the melter manual.

DuraBlue instructions on page 5.

Continue



DuraBlue Adhesive Melters

Replacing the Thermostat

Note: A DuraBlue melter has only one thermostat.

WARNING: Risk of electrocution! The control switch does not remove high-voltage power from the melter. Before opening the electrical compartment door, ensure that the local power disconnect switch is in the off position and locked. Failure to properly disconnect the power from the melter can result in personal injury, including death.

1. Switch the melter off.
2. Disconnect power to the melter at the local power disconnect switch.
3. Remove the electrical cover assembly and the right-side coupling cover.

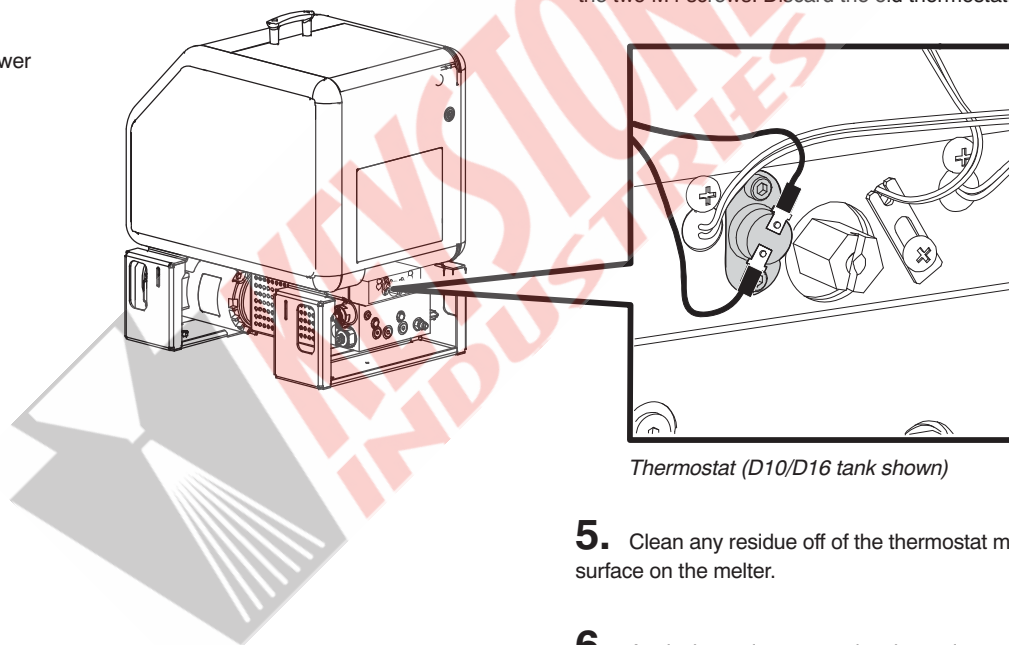
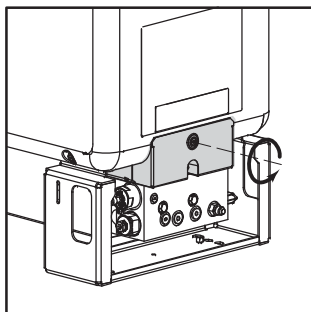

Thermostat (D10/D16 tank shown)

4. Disconnect the thermostat leads, and then remove the two M4 screws. Discard the old thermostat.

5. Clean any residue off of the thermostat mating surface on the melter.

6. Apply thermal compound to the replacement thermostat, install it using the M4 screws, and then connect the leads.

7. Reverse steps 1–3 to complete the thermostat replacement.

8. After switching the melter on, ensure that the melter operates correctly by monitoring the melter until it reaches ready status.